

User Manual

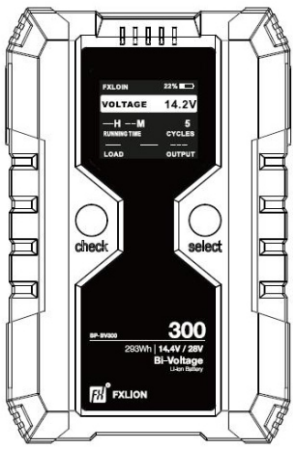

Bi-Voltage Battery

Thank you for choosing to use the FXLION products
In order to enable you to correctly use, store and maintain the products,
please read the instructions carefully.



BP-BV300 BP-BV200

Packing List: 1. Battery BP-BV300 *1/BP-BV200 *1 2. User Manual *1

I Features Product Appearance

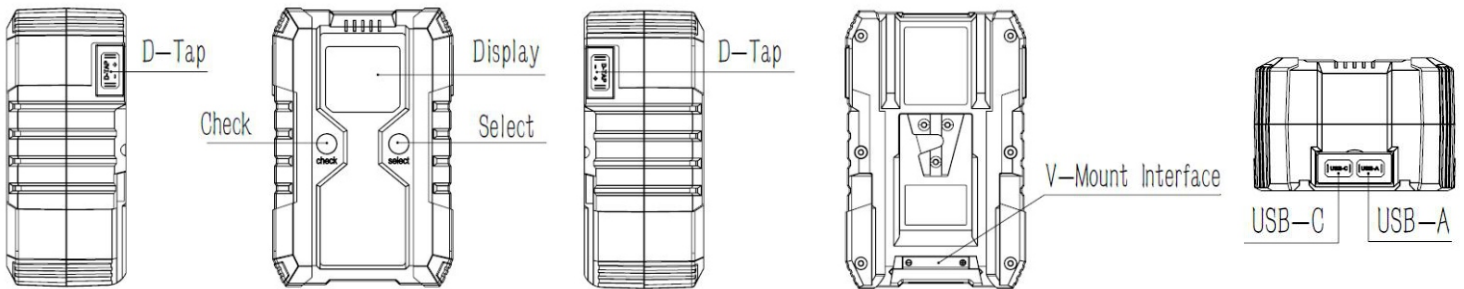

II Battery Basic Features

- Patented intelligent program, without any external accessories, the battery can automatically switch voltage 14.4V/28.8V intelligently.
- Bi-voltage battery, can output 14.4V power the camera and lighting, also can output 28.8V power camera and high power lighting.
- With 2*D-Tap, 1*USB-C and 1*USB-A multiple outputs options for equipment power supply.
- More safe and compatible structure, with rubber corners can adapt to falling in the work without damaging the shell.
- The ultra volume energy ratio design, use high power cells, rechargeable Li-ion battery, no memory effect.
- Build in smart PCB for over-heat, over-charge, over-discharge and over-current protections.

- 5-level indicators.
- Precise program control show battery cycles/battery voltage/battery current/power Percentage on LCD screen.
- Build in smart communication system, can display the battery voltage / battery capacity / operating time / working current on the camera with communication function.
- Can be charged by 16.8V V-lock or USB-C charger, no need use 28V charger. Use special materials for battery negative and positive can bear the temperature up to 230°C, The problem of high-temperature damaged components caused by high current discharge is solved.

III Specification

BP-BV300	
Capacity	14.4V 20.4Ah 293Wh / 28.8V 10.2Ah 293Wh
Battery Output	14.4V/18A (Max) / 28.8V/10A (Max)
D-tap*2 Output	14.4V/10A(Max) when battery in 14.4V status 16.0V/4A(Max) when battery in 28.8V status
USB-A Output	5V/2.4A, 9V/2A, 12V/1.5A
USB-C Input/Output	5V/3A, 9V/3A, 12V/3A, 15V/3A, 20V/3A, PD fast charge protocols, available only when battery in 14.4V status.
Discharge Temperature	-20°C~+55°C
Charge Temperature	0~+45°C
Dimension	154mm (L)*100mm(W)*85mm(H)
Weight	1650g

BP-BV200	
Capacity	14.4V 13.6Ah 196Wh / 28.8V 6.8Ah 196Wh
Battery Output	14.4V/18A (Max) / 28.8V/10A (Max)
E-Tap*2 Output	14.4V/10A(Max) when battery in 14.4V status 16.0V/4A (Max) when battery in 28.8V status
USB-A Output	5V/2.4A, 9V/2A, 12V/1.5A
USB-C Input/Output	5V/3A, 9V/3A, 12V/3A, 15V/3A, 20V/3A, PD fast charge protocols, available only when battery in 14.4V status.
Discharge Temperature	-20°C~+55°C
Charge Temperature	0~+45°C
Dimension	154mm (L)*100mm (W)*66mm (H)
Weight	1195g

IV Bi-voltage Selection

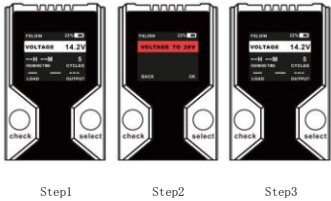

- 1) Press CHECK button to see battery power status, voltage from 12V to 16.8V.
- 2) Keep press SELECT button 3 seconds, display turn to 28V flash in red and white.
- 3) Press CHECK button in 3 seconds or do nothing, battery voltage turn back to 14.4V.

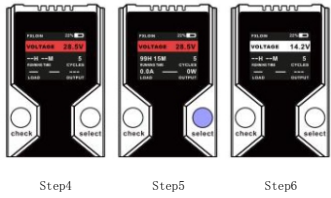

- 4) Press SELECT button in 3 seconds, battery turn to 28V output status, display flash in red and white.
- 5) Attach battery to device in 60 seconds, 28V output is locked, SELECT button light turn on, display show battery information.
- 6) Remove battery from device, battery voltage turn back to 14.4V from 28V.

VI Storage and Transportation

- Battery should be charged to 50% power status when need long term storage, charge and discharge once every three months.
- Place in a dry and cool places, avoid touching corrosive substances and keep away from fire.
- Storage temperature: -20°C~+25°C (12 months), -20°C~+45°C (3 months), -20°C~+60°C (1 month). Storage humidity: ≤75% RH.
- Batteries should be packed into boxes for transport which should prevent severe vibration, shock or extrusion, sun exposed and rain. transportation could be used cars, trains, boats and airplane.

VIII The warranty will not cover the following cases.

- Non Fxlion products, or out of warranty period.
- Non Fxlion tieline and power supply connection caused failure.
- Damage to device because of incorrect battery voltage selection.
- Battery unable to charge or full charged because of long term use of non Fxlion charger or charger Fxlion doesn't recommend.
- The phenomenon of a natural decrease in battery capacity caused by multiple charging and discharging cycles after a period of use.

Product Production Information

Model	Production Date
Serial Number	

Strict quality control procedures were done to every Fxlion product before it leaves the factory.

Please contact local Fxlion distributor or call our service center

at +86 10 8879 8684 for assistance.

V Caution

- Must accordance with instructions to use and store.
- Please charge by Fxlion charger or Fxlion recommended charger.
- Do not put battery into water or fire.
- Avoid strong impact.
- Do not heated or disassemble.
- Avoid short-circuit.
- Keep away from children.
- Battery should be charged to 50% power status when need long time storage, charge and discharge once every three months.

VII Maintenance and After-sales Service

- Battery warranty period is one year. Battery shell, rubber cap and V-lock part are easily-worn parts which warranty period is 3 months.
- Warranty period: start from the date of purchase with the record on warranty card and purchase/sales invoice.
- Disassemble or repair by non-professionals, or failure by dropping.
- Damage caused by man-made improper use.
- Battery capacity decrease because not accordance with instruction to use and store, make sure to charge and discharge once every three months, and keep battery capacity 50% for store.
- Force majeure: Do not work or parts damage caused by earthquake, fires and other natural disasters or accidents.

Fxlion Electronic Co., Ltd.

WEB: www.fxlion.net

Email: info@fxlion.net